

STYXMILL ESTATE VILLAS

Block 7
58 Country Club Terrace



Features:

Double glazed aluminium joinery
Extensive built in lighting in every room
Tiled bathrooms with under-floor heating
The latest in insulation and noise control systems
Fully carpeted with a choice of four colour schemes
Fully fenced and landscaped ground level private courtyard
Double garaging
Heat pump air-conditioning
Designer kitchen with stone benchtop, built in oven and microwave, gas
Cooktop and dishwasher

STYXMILL ESTATE

Telephone: (03) 323 6991

Email: michelle@hinvestments.net

Address: 160a Hussey Road, Harewood, Christchurch

Website: www.styxmillestate.co.nz

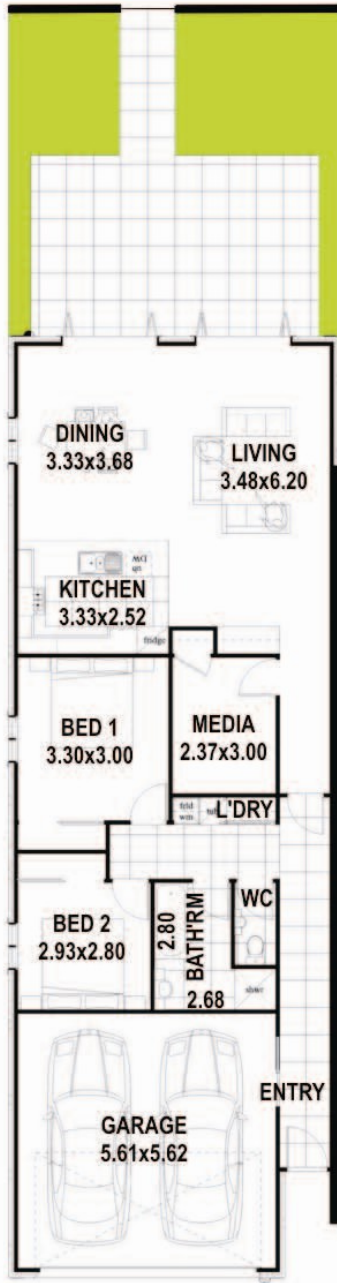

Site	304.2m ²
Ground Floor	146m ²
Out Door living	40m ²

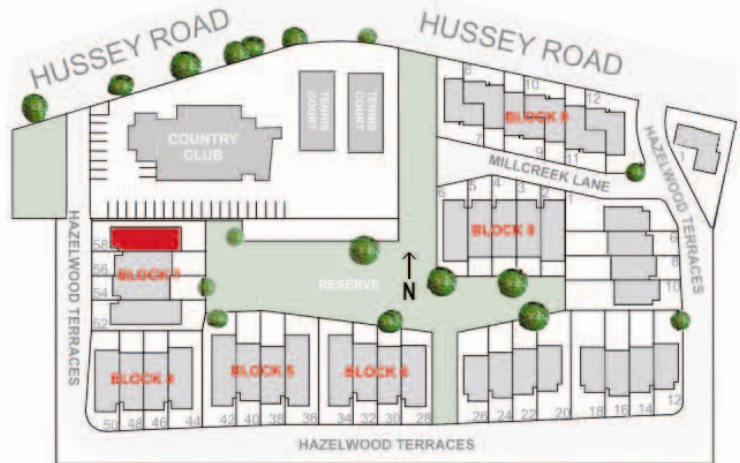

Please note this is a preliminary brochure based on artists impressions prepared prior to the final stages of development. Changes may be made to the proposed development plans during or after construction at the discretion of the developer. While every effort has been made to ensure that this information is true and correct at the time of printing, no responsibility will be taken for any errors, omissions, or changes. This publication does not constitute an offer for contract