

# STYXMILL ESTATE VILLAS

Block 8  
6 Millcreek Lane



## Features:

- Double glazed aluminium joinery
- Extensive built in lighting in every room
- Tiled bathrooms with under-floor heating
- The latest in insulation and noise control systems
- Fully carpeted with a choice of four colour schemes
- Fully fenced and landscaped ground level private courtyard
- Double garaging
- Heat pump air-conditioning
- Designer kitchen with stone benchtop, built in oven and microwave, gas cooktop and dishwasher

STYXMILL ESTATE

Telephone: (03) 323 6991

Email: [michelle@hinvestments.net](mailto:michelle@hinvestments.net)

Address: 160a Hussey Road, Harewood, Christchurch

Website: [www.styxmillestate.co.nz](http://www.styxmillestate.co.nz)

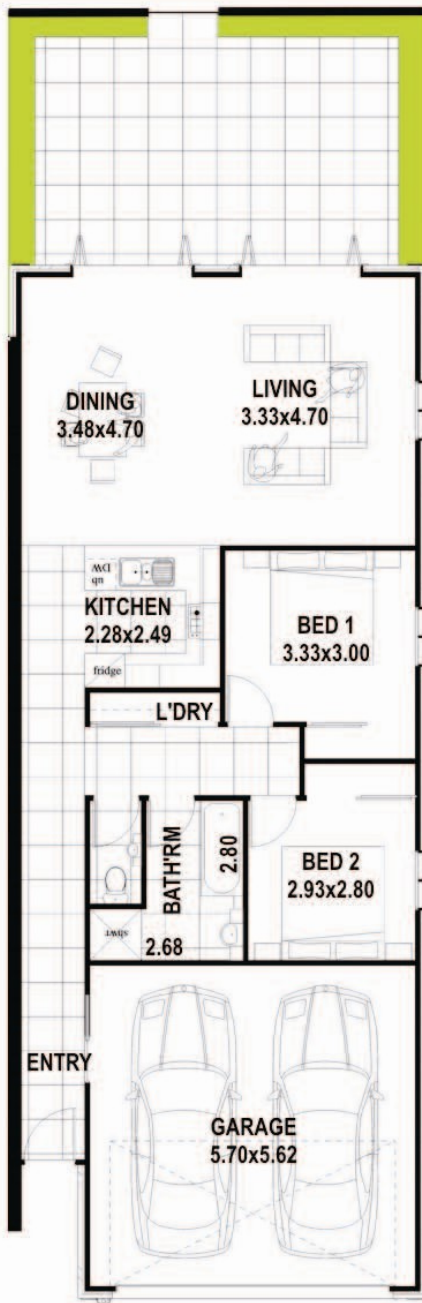

|                 |                     |
|-----------------|---------------------|
| Site            | 251.2m <sup>2</sup> |
| Ground Floor    | 126m <sup>2</sup>   |
| Out Door living | 40m <sup>2</sup>    |

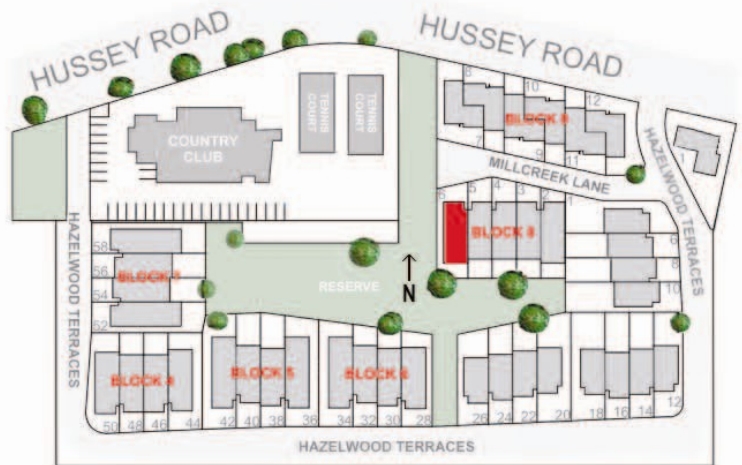

Please note this is a preliminary brochure based on artists impressions prepared prior to the final stages of development. Changes may be made to the proposed development plans during or after construction at the discretion of the developer. While every effort has been made to ensure that this information is true and correct at the time of printing, no responsibility will be taken for any errors, omissions, or changes. This publication does not constitute an offer for contract